



CASE STUDY | Children's Hospital



This national leader in pediatric care is dedicated to creating the future of pediatric health care. By considering every detail—every decision—every aspect of the care they provide for every child—the future health and potential of all children is being shaped. Here, doctors are revolutionizing children's health today along with the health of future generations.

Vanerum Studio has been collaborating with the dealer and customer since construction started for this new hospital. In the beginning, the customer wanted a small utility cart that blended with patient room furnishings to create a homey atmosphere. Studio collaborated with a team of nurses who will be using the carts on a daily basis. The Studio process resulted in a series of design iterations and four prototypes. The prototypes allowed them to test the cart and reveal new needs. Changes in height, drawers, pullout shelves, materials, locks, casters, grommet placements—the nurses tested and recorded their findings to design the ideal solution for their needs. What was once a simple storage cabinet has evolved into a highly technical mobile cart that holds specific medical devices and supplies. (Pages 2-5 to illustrate the process from start to finish.)

The Studio Process helped the customer understand their needs and to maximize function of the patient room cart through seeing multiple iterations. Studio's commitment and passion for user needs created a great relationship with the customer. A series of other products have been developed (see pages 6-7).



A photograph of a mobile medical cart. It features a white countertop with a built-in sink and a chrome faucet. Below the countertop, there are two large wooden cabinets with arched cutouts at the top. To the right of these cabinets is a tall wooden cabinet with five drawers, each with a silver handle. The cart is on casters and is positioned next to a white wall and a wooden door.



Technical drawings of a mobile filing cabinet, including a top view, a front elevation, and a side elevation. The top view shows a square footprint with dimensions 24.000 (width) and 24.000 (depth). A central rectangular area is marked with dimensions 5.433 (width) and 2.717 (depth). A handwritten note "Drawer liners removable 'plastic'" points to this central area. The front elevation shows a height of 33.000 and a width of 24.000. It features a "Posting Shelf" at the top, a "Posting Shelf Front" at the bottom, and a "Pull Bar" on the right side. The side elevation shows a height of 33.000 and a width of 24.000. It features a "Posting Shelf" at the top, a "Posting Shelf Front" at the bottom, and a "Drawer Dividers (Plastic)" on the right side. A handwritten note "Flip up writing serv" points to the "Posting Shelf Front". The bottom of the cabinet is labeled "Non locking casters".

Design Iterations



MONITOR ARM

remove & o back-to-front
underneath Full Extension Slides
w/ -inverted Pull

Thermofix Top Surface
white laminate

24.000

*Monitor Arm Provided by Other

SPEC: 127270185

- Mobile Storage Cart
- 24"W x 34"D x 62"H
- Thermofix Veneer/surface w/Medical M951
- Standard: Etc mounting a 6W x 12H laminate Panel, to be used for mounting Scanner Charger
- Full Car Keyboard Tray w/ Full Extension Slides
- Full Cut Shelf on left Side of Cart w/Rollwood BBS Concealed Edge Roll
- 2 Grammate in Back Row (Medical ISO Series)
- 4 Drawers w/Gang lock
- 2 Locking Casters
- 2 Roll-Over Stops
- 4 Outlet Surge Protector

24.000

55.250

2" Opening Behind Drawer Rows to Allow Wires to Feed to Surge Protector

1 drawer 6W x 24" Gangmate (Conforms to Back Row)

1 drawer 6W x 24" Gangmate (Conforms to Back Row)

4 Outlet Surge Protector w/2 Tower Caster

2" Dia. Gangmate Hole in Base

1" PVC Rollwood Base

locking Caster: NQO3AM125SW/PR1 Chemical Resistant / Anti-Microbial

Small Custom Extended Plastic Tray Insert

Medium Custom Extended Plastic Tray Insert

Large Custom Extended Plastic Tray Insert

Extra Large Custom Extended Plastic Tray Insert

no plastic

no plastic

Patient Cart Mock up 3

Design Iterations

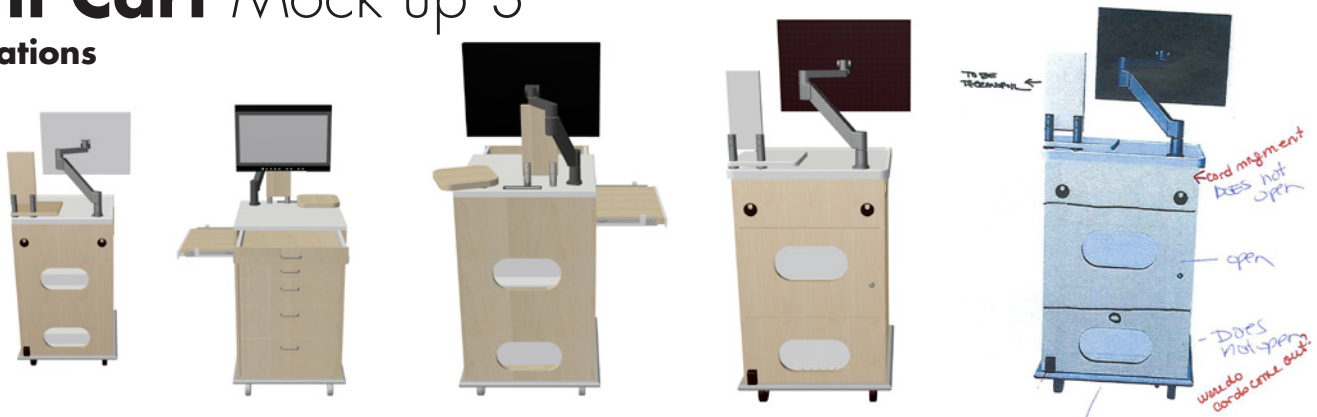

Mock up 3 Patient Cart



Mock up 3 Patient Cart Revisions

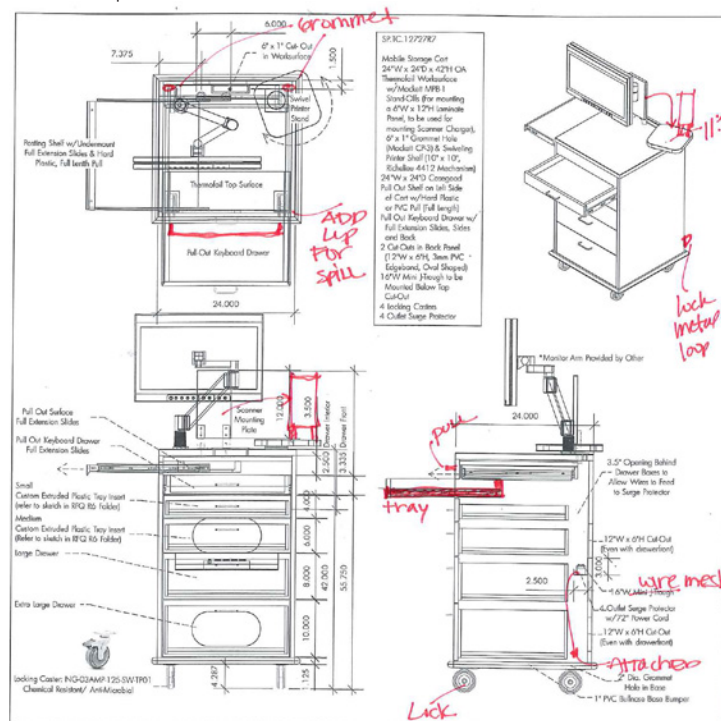

Patient Cart Mock up 4

Design Iterations

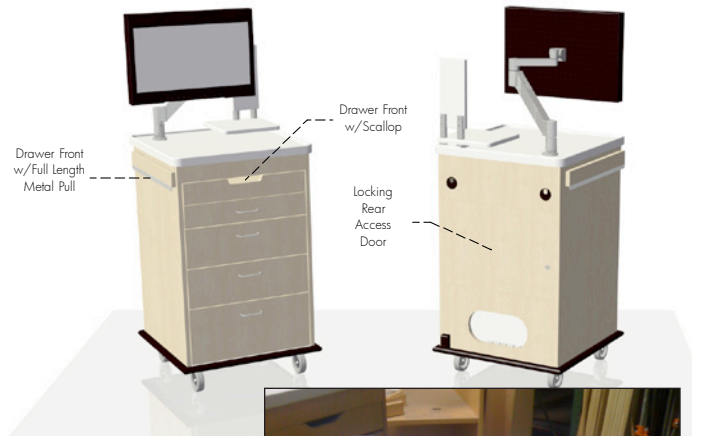
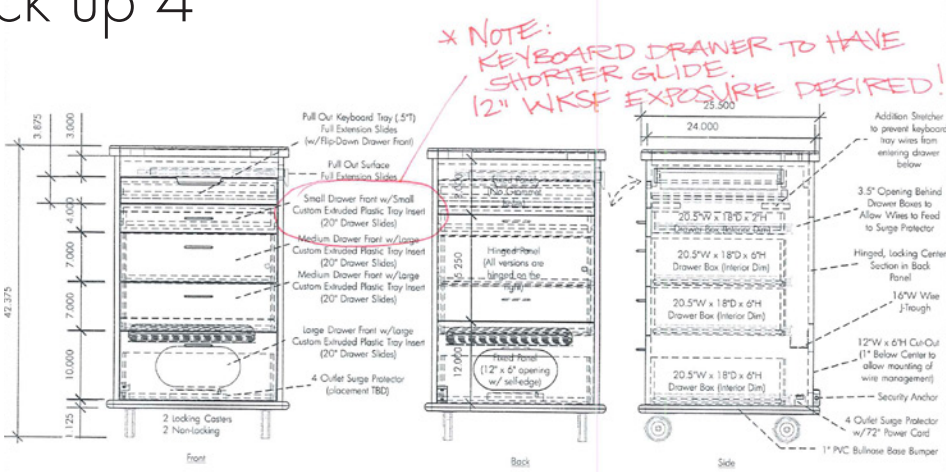

Mock up 4 **Patient Cart**



Critical Care Cart



Height Adjustable Cart



Night Stand



Computer Carrel



Storage Cube

