

Astute Hard Plastic Desks

Part Numbers: 59082, 59083, 59084, 59085, 59086, 59087, 59088, 59089

SURFACE:

The table top is made of a hard plastic shell on a 3/5" wood flour core.

FRAME AND LEGS:

The table leg assembly consists of a 1-1/8" diameter 16-gauge powder coated steel leg insert, and a 0.944" 16-gauge chrome-plated steel leg insert.

The powder coated leg insert is attached to the frame with two M8-1.25 Allen screws. The leg receiver and plate are welded to a 20-gauge frame. Legs are directly mounted and pre-installed to the top with four screws.

The steel leg insert has pierced and tapped holes for the screws to be installed and adjusted for height. The steel legs are standard with nylon glides with a M10-1.5 threaded stem that are pre-installed into the leg. Overall leg adjustment range is from 23-1/8" to 33-1/8" in 2" increments. An additional hole is provided for adjusting 1" shorter, so the shortest height possible is 22-1/8". One M8-1.25 set screw with an Allen wrench is used to tighten the steel leg insert at the chosen height.

BOOK BOX:

The book box is made of 20-gauge powder coated steel in platinum and comes pre-installed to the table. See below for dimensions which depend on the desk shape. The corners are bent into a 0.098" radius.

OPTIONS/ACCESSORIES:

The top laminate is available with different color options.



LAMINATE OPTIONS:



Fusion
Maple



Grey
Nebula

FRAME AND LEGS:



Platinum

SMALL MONROE:

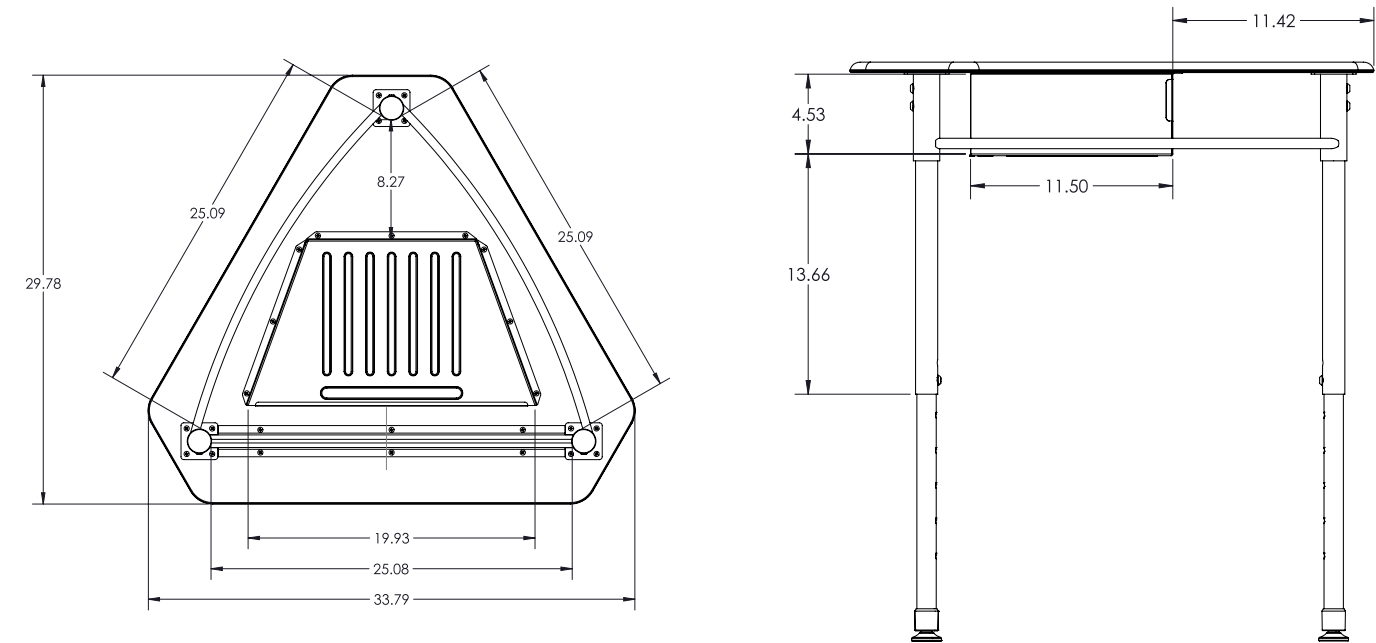

RECTANGLE:

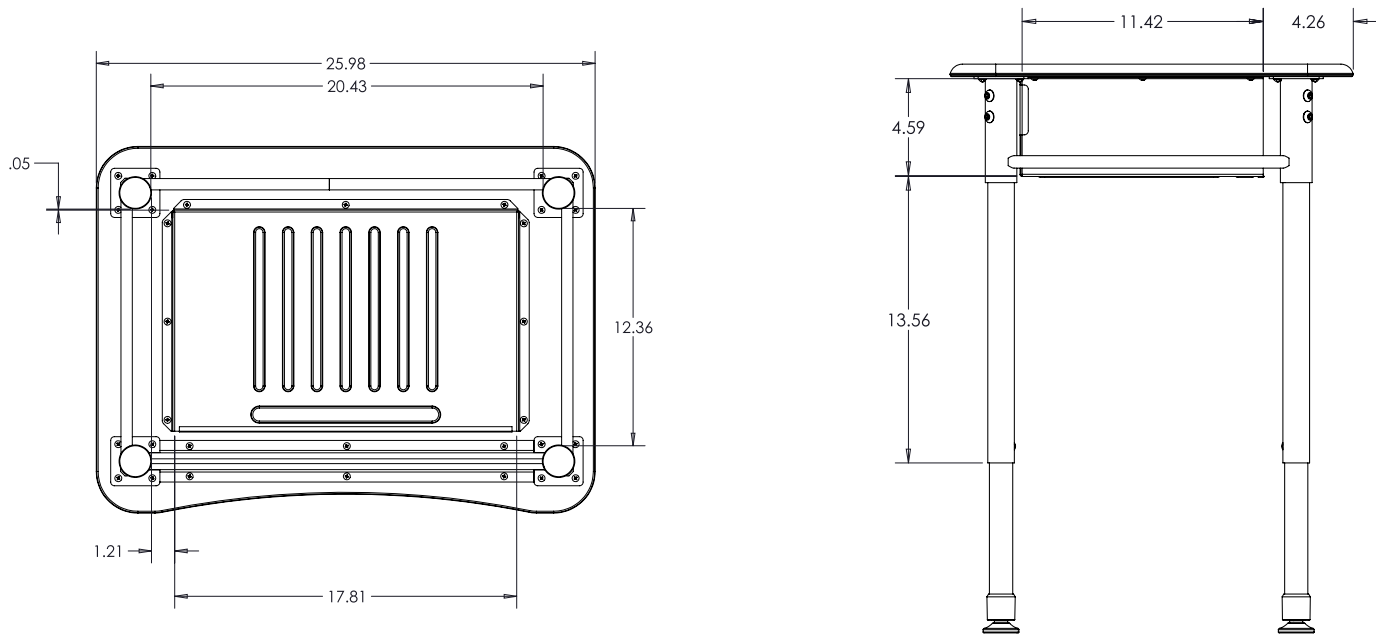

DIMENSIONS:

Base Model No.	Description	Height - Min. "	Height - Max. "	Overall Depth "	Overall Width "
59082	Astute Hard Plastic Desk - Rectangle - Fusion Maple	22.125"	33.125"	19.3"	26"
59083	Astute Hard Plastic Desk - Rectangle - Grey Nebula	22.125"	33.125"	19.3"	26"
59086	Astute Hard Plastic Desk - Small Monroe - Fusion Maple	22.125"	33.125"	29.8"	33.8"
59087	Astute Hard Plastic Desk - Small Monroe - Grey Nebula	22.125"	33.125"	29.8"	33.8"



MOORECO INC.
2885 Lorraine Avenue | Temple, TX 76501
p: 800.749.2258 | f: 866.888.7483
www.moorecoinc.com