

Hierarchy Beam Desk

Part Number(s): 59077-66691-PORC-CHAR,
59077-66692-PORC-CHAR, 59077-66691K-PORC-CHAR,
59077-66692K-PORC-CHAR, 59077-66691S-PORC-CHAR,
59077-66692S-PORC-CHAR,

TOP:

The top is made of 1 1/8" Particleboard Core with 3mm Flat Vinyl T-Mold Edge. The work surface is constructed of 45# particleboard core with high-pressure laminate (HPL) top surface and phenolic backer sheet for balanced construction. 1 1/8" 3mm flat vinyl t-mold is secured to the work surface with brad nails along the perimeter. Overall top thickness of 1.25".

LEG (KIDS & STANDARD HEIGHT):

The 1.5" diameter 14 gauge powder coated leg receiver is welded to a 10 gauge steel top plate and two 12 gauge gussets for strength. Legs are directly mounted to the top with six #10 x 1" wood screws. The leg insert is a 34mm 17-gauge chrome plated steel tube with welded in threaded glide insert. Legs are standard with nylon glides that have 3/4" height adjustment range for leveling, and an M10 threaded stem. 50mm single urethane wheel casters with a M10 threaded stem are available for easy field installation in locking and non-locking. Casters add 3" of height to the desk.

LEG (STANDING HEIGHT):

The 1.75" diameter 9 gauge powder coated leg receiver is welded to a 10 gauge steel top plate and two 10 gauge gussets for strength. Legs are directly mounted to the top with nine #10 x 1" wood screws. The leg insert is a 40mm 11-gauge chrome plated steel tube with press fit plastic cap. Legs are standard with M10 nylon glides. 60mm dual wheel soft casters with threaded stem are available in locking and non-locking. Casters add 2" of height to the desk.

HEIGHT ADJUSTMENT:

Adjustment range is from 18"-29" in 1" increments for standard legs, 12"-18" for kids height legs, and 27" - 42" for the standing height leg option. Two M6 x 15MM low profile socket head screws with an allen drive are used to tighten the leg insert at the chosen height for kids and standard height legs. Standing height leg uses a single M6 set screw to fix the height.

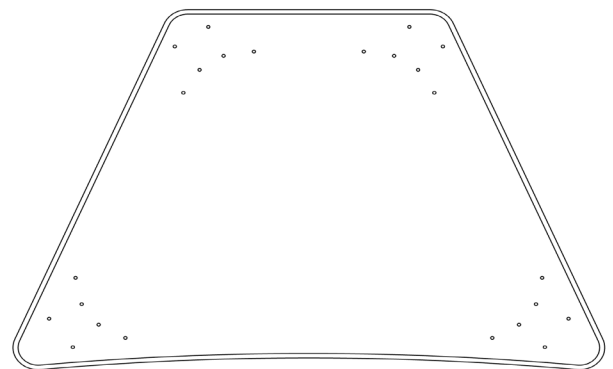

OPTIONS / ACCESSORIES:

All Hierarchy desk and table tops are available with a variety of laminate and edgeband options, as well as black or platinum legs.

Optional accessories include a pair of casters, backpack hook, enclosed book box, ganging device, and clamp mounted electrical unit.

COMPLIANCE:

SCS Indoor Advantage Gold certified.

All Shapes Desks pass BIFMA table and leg static load tests as well as leg pull test requirements.

LAMINATE + MATCHING EDGE BAND:



COLORLED EDGE BAND:



LEG COLOR:

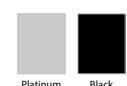

HIERARCHY BEAM DESK

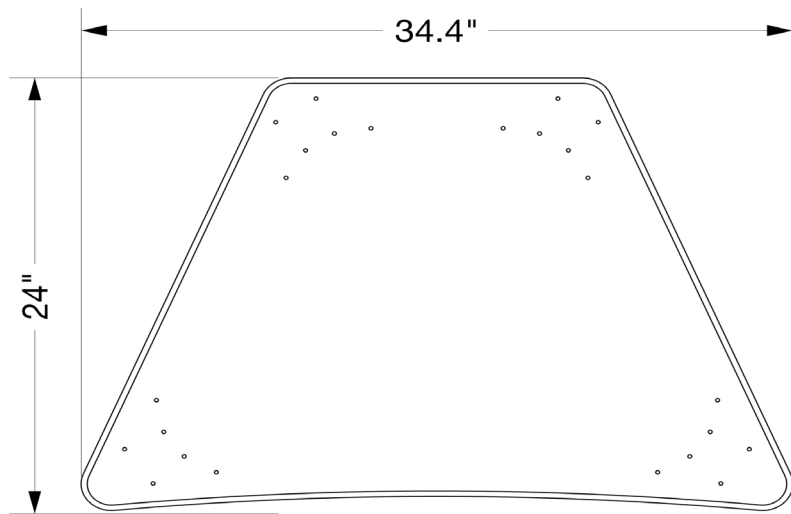

DIMENSIONS:

PART NO.	ITEM	DIMENSIONS	SHIP WT.
PRODUCT			
59077-66691-PORC-CHAR	Hierarchy Beam Desk + Porcelain Steel Top - Black Legs	18" - 29"H × 34.4"W × 23.9"D	60 lbs
59077-66692-PORC-CHAR	Hierarchy Beam Desk + Porcelain Steel Top - Platinum Legs	18" - 29"H × 34.4"W × 23.9"D	60 lbs
59077-66691K-PORC-CHAR	Hierarchy Beam Desk + Porcelain Steel Top - Black Legs (Youth Height)	12" - 18"H × 34.4"W × 23.9"D	60 lbs
59077-66692K-PORC-CHAR	Hierarchy Beam Desk + Porcelain Steel Top - Platinum Legs (Youth Height)	12" - 18"H × 34.4"W × 23.9"D	60 lbs
59077-66691S-PORC-CHAR	Hierarchy Beam Desk + Porcelain Steel Top - Black Legs (Standing Height)	27" - 42"H × 34.4"W × 23.9"D	60 lbs
59077-66692S-PORC-CHAR	Hierarchy Beam Desk + Porcelain Steel Top - Platinum Legs (Standing Height)	27" - 42"H × 34.4"W × 23.9"D	60 lbs



MOORECO™

2885 Lorraine Avenue | Temple, TX 76501
p: 800.749.2258 | f: 866.888.7483
www.moorecoinc.com

HIERARCHY STUDENT DESK LEG OPTIONS

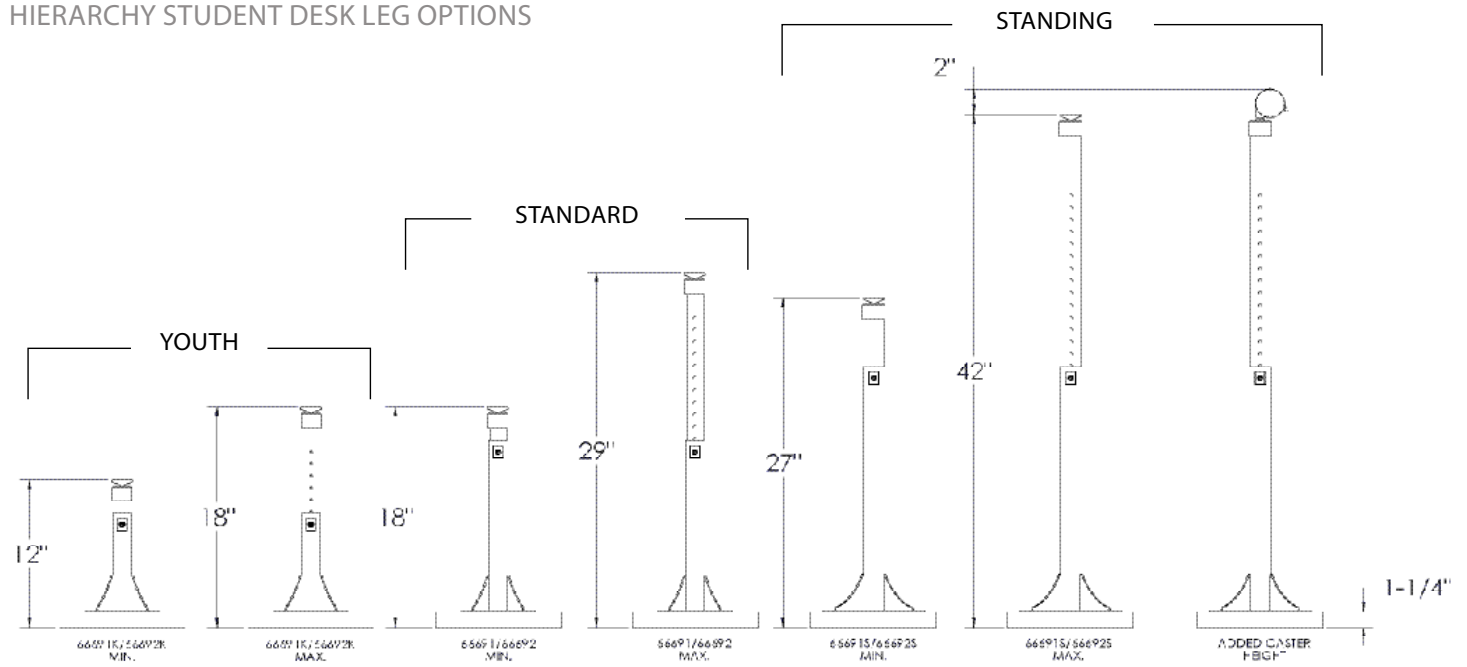

CASTER OPTION

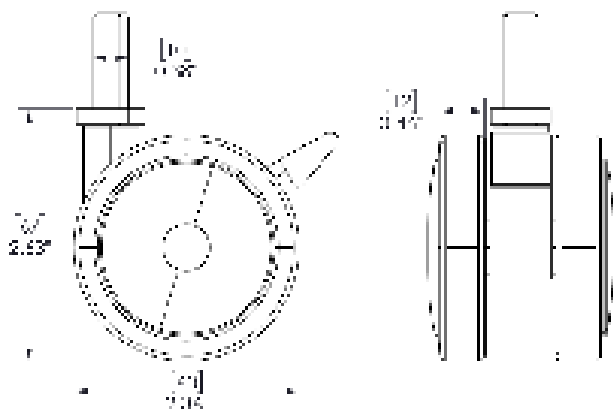

NYLON GLIDES (STANDARD)

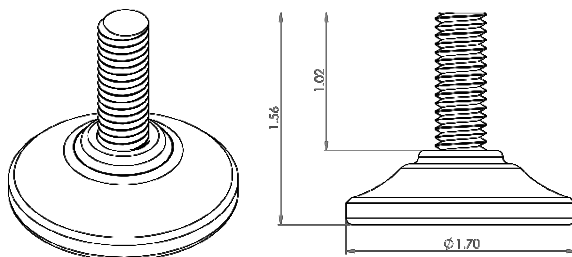

PACK HOOK

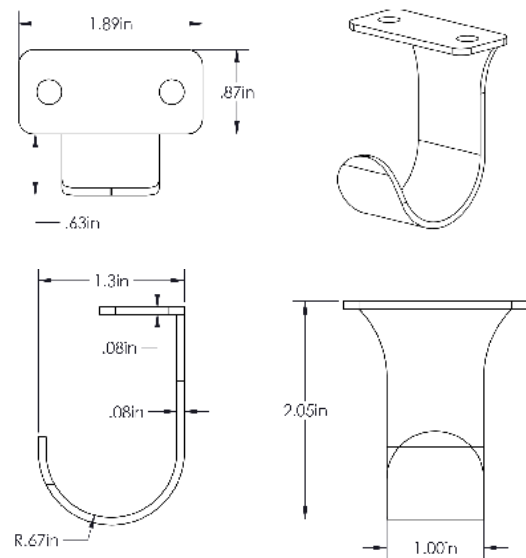

CUP HOLDER

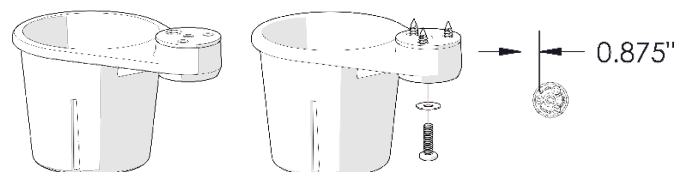

ENCLOSED BOOK BOX

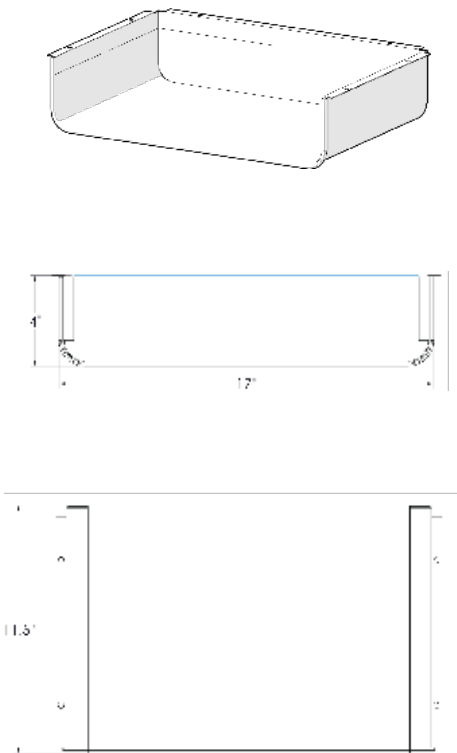

WIRE BOOK BOX

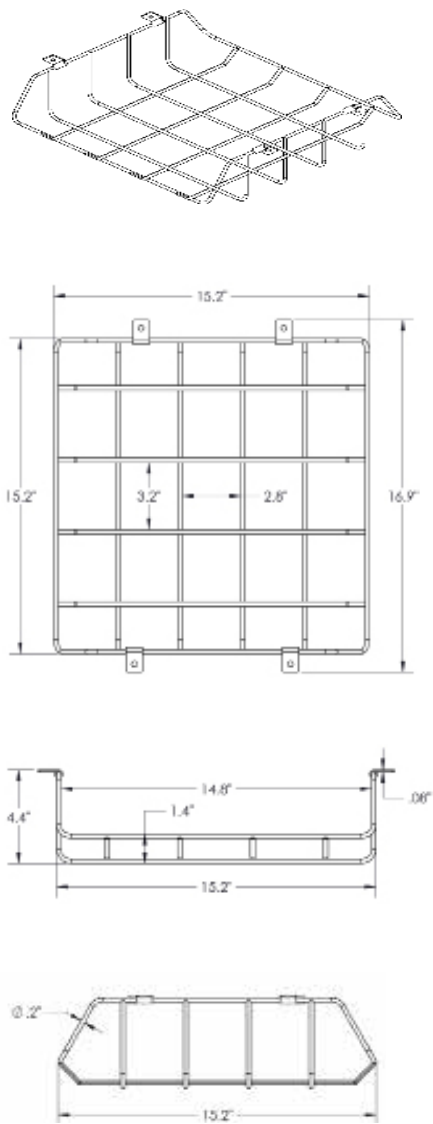

TOTE TRAY II

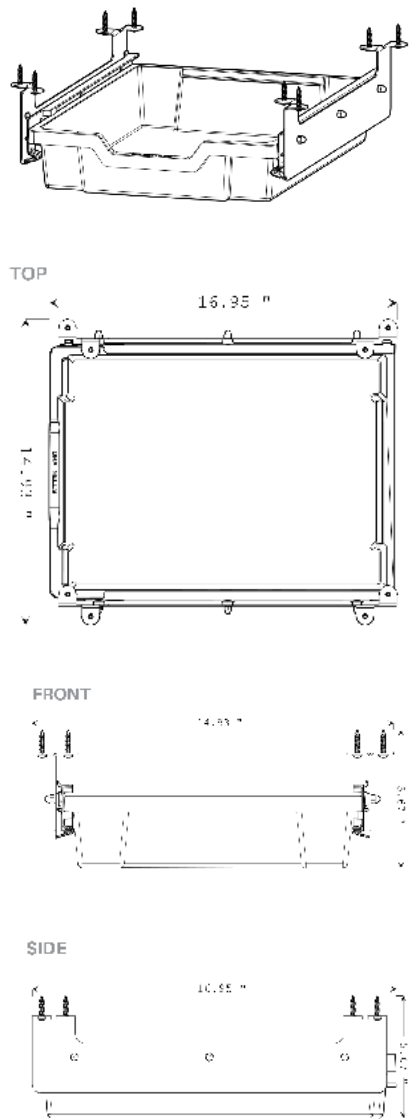

ACCESSORIES:

Base Model No.	Description
12934	Student Desk Casters
45131	Tote Tray II
66669	Pack Hook (Set of 2)
59019	Student Desk Cup Holder
66633	Enclosed Book Box (Platinum)
66662	Wire Book Box (Chrome)
66675	Clamp Mount Outlet & USB Charger

CLAMP MOUNT OUTLET & USB CHARGER

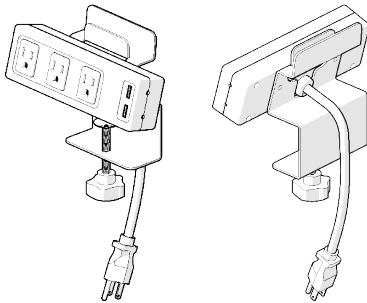

ITEM	SPECIFICATION
AC Charging Ports	Two (2)
AC Output	750W (60)
Locking Mounting	12A, locked down 30A due to UL 1664A, 125V, 60/50Hz
EMI/RFI Noise Attenuation	150dB (100MHz) up to 100MHz
USB Ports	50% 1A, 50% 2.1A
Certification	UL/ETL Listed
Power Cord	10' / 30mm



2885 Lorraine Avenue | Temple, TX 76501
p: 800.749.2258 | f: 866.888.7483
www.moorecoinc.com